

Kan. Cong. Dist. No. 5

Joe Skubitz

Form 10-300
(July 1969)

UNITED STATES DEPARTMENT OF THE INTERIOR
NATIONAL PARK SERVICE

NATIONAL REGISTER OF HISTORIC PLACES INVENTORY - NOMINATION FORM

(Type all entries - complete applicable sections)

STATE: Kansas	
COUNTY: Butler	
FOR NPS USE ONLY	
ENTRY NUMBER	DATE

1. NAME

COMMON:
Augusta Historical Museum

AND/OR HISTORIC:
C. N. James Cabin (preferred name)

2. LOCATION

STREET AND NUMBER:
305 State street

CITY OR TOWN:
Augusta

STATE Kansas 67010	CODE 20	COUNTY: Butler	CODE 015
-----------------------	------------	-------------------	-------------

3. CLASSIFICATION

CATEGORY (Check One)	OWNERSHIP	STATUS	ACCESSIBLE TO THE PUBLIC
<input type="checkbox"/> District <input type="checkbox"/> Site <input type="checkbox"/> Object <input checked="" type="checkbox"/> Building <input type="checkbox"/> Structure 	<input type="checkbox"/> Public <input checked="" type="checkbox"/> Private <input type="checkbox"/> Both 	Public Acquisition: <input type="checkbox"/> In Process <input type="checkbox"/> Being Considered <input checked="" type="checkbox"/> Occupied <input type="checkbox"/> Unoccupied <input type="checkbox"/> Preservation work in progress	Yes: <input checked="" type="checkbox"/> Restricted <input type="checkbox"/> Unrestricted <input type="checkbox"/> No
PRESENT USE (Check One or More as Appropriate)			
<input type="checkbox"/> Agricultural <input type="checkbox"/> Commercial <input type="checkbox"/> Educational <input type="checkbox"/> Entertainment	<input type="checkbox"/> Government <input type="checkbox"/> Industrial <input type="checkbox"/> Military <input checked="" type="checkbox"/> Museum	<input type="checkbox"/> Park <input type="checkbox"/> Private Residence <input type="checkbox"/> Religious <input type="checkbox"/> Scientific	<input type="checkbox"/> Transportation <input type="checkbox"/> Other (Specify) _____ _____ <input type="checkbox"/> Comments _____ _____

4. OWNER OF PROPERTY

OWNER'S NAME:
Augusta Historical Society

STREET AND NUMBER:
303 State street

CITY OR TOWN:
Augusta

STATE: Kansas	CODE 20
------------------	------------

5. LOCATION OF LEGAL DESCRIPTION

COURTHOUSE, REGISTRY OF DEEDS, ETC:
Register of Deeds

STREET AND NUMBER:
Butler County Courthouse

CITY OR TOWN:
El Dorado

STATE: Kansas	CODE 20
------------------	------------

6. REPRESENTATION IN EXISTING SURVEYS

TITLE OF SURVEY:
A Survey of Historic Sites and Structures in Kansas

DATE OF SURVEY: 1957 Federal State County Local

DEPOSITORY FOR SURVEY RECORDS:
Kansas State Historical Society

STREET AND NUMBER:
120 West Tenth street

CITY OR TOWN:
Topeka

STATE: Kansas	CODE 20
------------------	------------

SEE INSTRUCTIONS

015-0310-003
6/17/81

STATE: Kansas
COUNTY: Butler
ENTRY NUMBER
DATE

7. DESCRIPTION

CONDITION	(Check One)					
	<input type="checkbox"/> Excellent	<input type="checkbox"/> Good	<input checked="" type="checkbox"/> Fair	<input type="checkbox"/> Deteriorated	<input type="checkbox"/> Ruins	<input type="checkbox"/> Unexposed
	(Check One)			(Check One)		
	<input checked="" type="checkbox"/> Altered	<input type="checkbox"/> Unaltered	<input type="checkbox"/> Moved	<input checked="" type="checkbox"/> Original Site		

DESCRIBE THE PRESENT AND ORIGINAL (If known) PHYSICAL APPEARANCE

The C. N. James Cabin (now an Augusta Historical Museum building) in Augusta is a log structure in the frontier style of architecture. The rectangular building measures approximately 35 feet long and 20 feet wide and is two stories in height. The building is constructed of rough hewn logs chinked with mortar. The logs are roughly squared and interlock at the corners. The interlocking corner logs are notched so that they rest in each other and leave only a small space between logs. The roof is a steep gable covered with wood shingles. The roof overhangs the wall below with a simple soffit and a plain cornice. The end walls at the gable are covered with horizontal clapboard siding painted green. A massive stone chimney is located on the west end and runs exposed on the outside of the building. Windows on the first floor and the gable end are narrow rectangles of the four pane double-hung sash type. The logs of the walls form the window sills and the lintels. The second floor windows along the sides are small and square and are not operable. These are located up under the roof overhang. All window trim is painted green to match the clapboard siding. The main entrance is on the east end.

The building was altered extensively over the years but was later restored to a condition much like the original. It is now used as a museum.

A modern metal museum building has been constructed about six feet south of the cabin. A flat-roofed concrete block passage now connects the two buildings at the southwest corner of the cabin and provides controlled access to the cabin.

SEE INSTRUCTIONS

SEE INSTRUCTIONS

SIGNIFICANCE			
PERIOD (Check One or More as Appropriate)			
<input type="checkbox"/> Pre-Columbian	<input type="checkbox"/> 16th Century	<input type="checkbox"/> 18th Century	<input type="checkbox"/> 20th Century
<input type="checkbox"/> 15th Century	<input type="checkbox"/> 17th Century	<input checked="" type="checkbox"/> 19th Century	
SPECIFIC DATE(S) (If Applicable and Known) 1868			
AREAS OF SIGNIFICANCE (Check One or More as Appropriate)			
<input type="checkbox"/> Aboriginal	<input type="checkbox"/> Education	<input type="checkbox"/> Political	<input type="checkbox"/> Urban Planning
<input type="checkbox"/> Prehistoric	<input type="checkbox"/> Engineering	<input type="checkbox"/> Religion/Phi-	<input checked="" type="checkbox"/> Other (Specify)
<input type="checkbox"/> Historic	<input type="checkbox"/> Industry	<input type="checkbox"/> Philosophy	Western settlement
<input type="checkbox"/> Agriculture	<input type="checkbox"/> Invention	<input type="checkbox"/> Science	_____
<input type="checkbox"/> Architecture	<input type="checkbox"/> Landscape	<input type="checkbox"/> Sculpture	_____
<input type="checkbox"/> Art	<input type="checkbox"/> Architecture	<input type="checkbox"/> Social/Human-	_____
<input type="checkbox"/> Commerce	<input type="checkbox"/> Literature	<input type="checkbox"/> itarian	_____
<input type="checkbox"/> Communications	<input type="checkbox"/> Military	<input type="checkbox"/> Theater	_____
<input type="checkbox"/> Conservation	<input type="checkbox"/> Music	<input type="checkbox"/> Transportation	_____
STATEMENT OF SIGNIFICANCE			
<p>The C. N. James cabin, now known as the Augusta Historical Museum, was originally built as a store and home in 1868. It was the first building erected on land which later became the townsite of Augusta. The builder was Chester N. James, a merchant from Council Grove who moved to Butler county in the spring of 1868 to establish a trading post with his partner, William F. Shamleffer. Construction of the 20- by 35-foot long structure was started shortly after James' arrival, and the business was opened in July, 1868. The James family made their home on the second floor until the summer of 1869; the lower floor contained the store.</p> <p>C. N. James was prominent in the development of the Augusta community. He was instrumental in the organization of Augusta township and in the incorporation of the town of Augusta, both of which were named after his wife. He also served as the town's first mayor and first postmaster.</p> <p>On the upper floor of the log building the Baptists held the first church services in the community in 1869; the local Methodists organized in 1870, using the same facilities. Under James' leadership the first Masonic lodge in the county was established in the upper room of his store. In 1868 the first district school at Augusta was organized and classes were held on the second floor of James' building from 1868 to 1870; the first teacher was L. N. Blood, a clerk in James' store.</p> <p>Over the years the James store had various uses and was somewhat altered. In the 1880's the log exterior was covered with siding and a flat roof replaced the original gable roof. In the late 1930's the Augusta Historical Society was organized, and in January, 1939, that group purchased the James building for \$350 to use as a museum. During the next two years money was raised to renovate the old log structure. The project, beginning in January, 1941, included removing the siding, re-constructing the gabled roof, chinking between the logs and adding a cement foundation. Restoration was completed that summer and open house was held June 22, 1941. Antiques and furnishings typical of the period when the James family occupied the house are now part of the museum.</p>			

NATIONAL REGISTER OF HISTORIC PLACES
INVENTORY - NOMINATION FORM

(Continuation Sheet)

STATE	
Kansas	
COUNTY	
Butler	
FOR NPS USE ONLY	
ENTRY NUMBER	DATE

(Number all entries)

8. The C. N. James store is important to the people of the Augusta community because it is the oldest and most significant historical structure in their town. The man who erected the building not only founded the town but also contributed greatly to its development. The building, by serving as the center of activity during the early years of the settlement, has assisted and shared in the growth of the community. It is also a good example of frontier log cabin architecture and is one of the few remaining two story log structures in the state.
9. Southern Kansas Gazette (Augusta), January 6, 1881.
Stratford, Jessie Perry, Butler County's Eighty Years, 1855-1935
(n.p., 1934), p. 19.
Walnut Valley Times (El Dorado), January 7, 1887; March 8, 1895.

9. MAJOR BIBLIOGRAPHICAL REFERENCES

Augusta Centennial, Inc.--Souvenir Historical Program (n. p., 1968).
 "Augusta," El Dorado Democrat, June 30, 1881.
Augusta Gazette, January 14, 1939; May 20, 1940; October 21, 1946; August 9, 1958.
El Dorado Times, May 26, 1961.
 "First Building Now a Museum," Wichita Morning Eagle, August 8, 1956.
History of the State of Kansas (Chicago, A. T. Andreas, 1883), pp. 1436, 1439.
Mooney, Vol. P., History of Butler County, Kansas (Lawrence, Kan., Standard Publishing Co., 1916), pp. 45, 46, 95, 96.

10. GEOGRAPHICAL DATA

LATITUDE AND LONGITUDE COORDINATES DEFINING A RECTANGLE LOCATING THE PROPERTY				O R	LATITUDE AND LONGITUDE COORDINATES DEFINING THE CENTER POINT OF A PROPERTY OF LESS THAN TEN ACRES										
CORNER	LATITUDE				LONGITUDE			LATITUDE			LONGITUDE				
	Degrees	Minutes	Seconds	Degrees	Minutes	Seconds	Degrees	Minutes	Seconds	Degrees	Minutes	Seconds			
NW	0	'	"	0	'	"	0	'	"	37	40	25	96	58	44
NE	0	'	"	0	'	"									
SE	0	'	"	0	'	"									
SW	0	'	"	0	'	"									

APPROXIMATE ACREAGE OF NOMINATED PROPERTY: **Less than one**

LIST ALL STATES AND COUNTIES FOR PROPERTIES OVERLAPPING STATE OR COUNTY BOUNDARIES

STATE:	CODE	COUNTY	CODE

11. FORM PREPARED BY

NAME AND TITLE: **Charles Hall, Architectural Consultant**
Richard Pankratz, Planner

ORGANIZATION: **Kansas State Historical Society** DATE: **August 30, 1972**

STREET AND NUMBER: **120 West Tenth Street**

CITY OR TOWN: **Topeka** STATE: **Kansas 66612** CODE: **20**

12. STATE LIAISON OFFICER CERTIFICATION

As the designated State Liaison Officer for the National Historic Preservation Act of 1966 (Public Law 89-665), I hereby nominate this property for inclusion in the National Register and certify that it has been evaluated according to the criteria and procedures set forth by the National Park Service. The recommended level of significance of this nomination is:

National State Local

Name Nyle H. Miller
Nyle H. Miller

Title Executive Director, Kansas State Historical Society

Date November 1, 1972

NATIONAL REGISTER VERIFICATION

I hereby certify that this property is included in the National Register.

Chief, Office of Archeology and Historic Preservation

Date _____

ATTEST:

Keeper of The National Register

Date _____

SEE INSTRUCTIONS

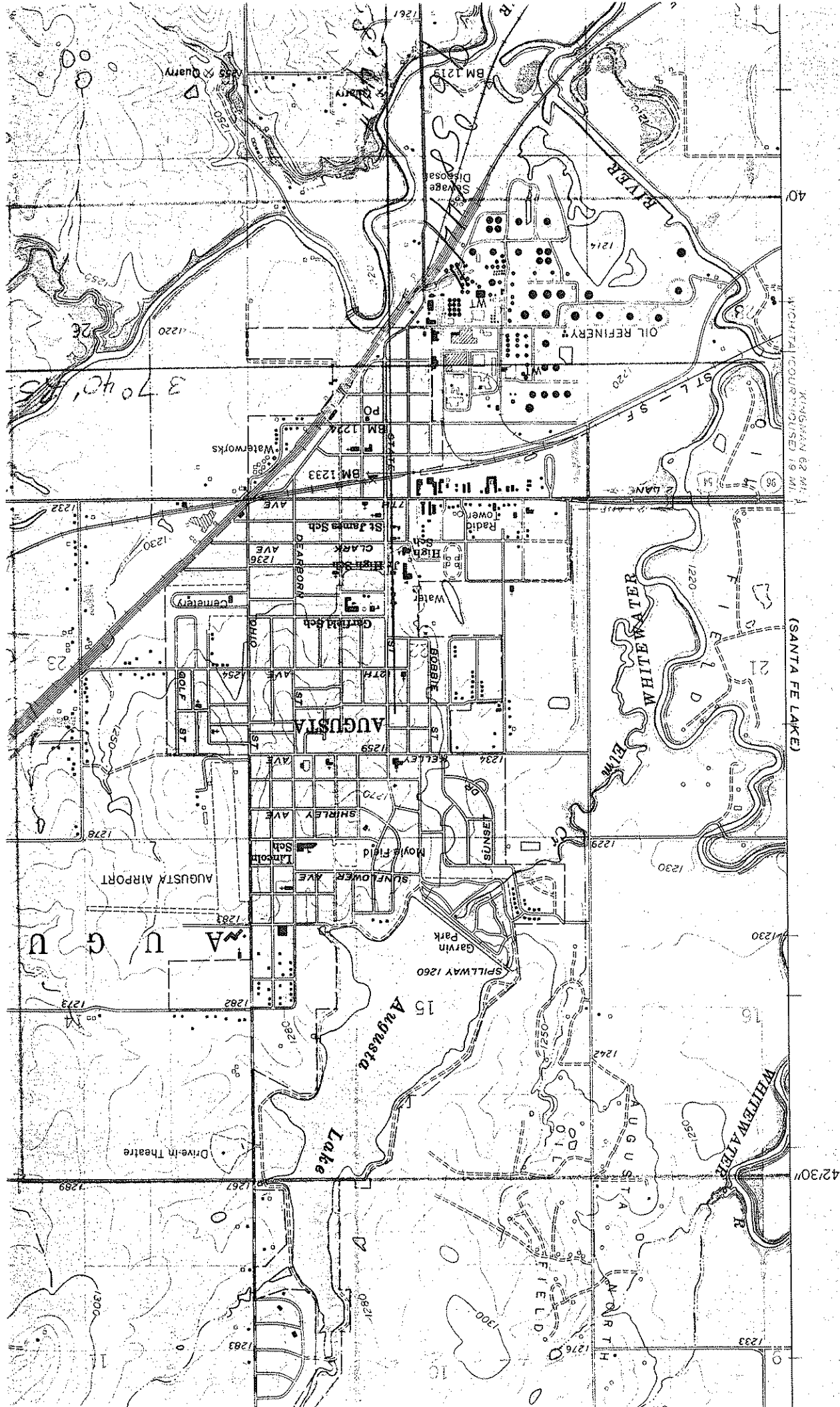

*August Quad
1961*