

UNITED STATES DEPARTMENT OF THE INTERIOR
NATIONAL PARK SERVICE

NATIONAL REGISTER OF HISTORIC PLACES
INVENTORY -- NOMINATION FORM

FOR NPS USE ONLY
RECEIVED
DATE ENTERED

SEE INSTRUCTIONS IN *HOW TO COMPLETE NATIONAL REGISTER FORMS*
TYPE ALL ENTRIES -- COMPLETE APPLICABLE SECTIONS

1 NAME

HISTORIC ARKANSAS CITY COUNTRY CLUB SITE (14C03)

AND/OR COMMON

2 LOCATION

East side of Arkansas City

STREET & NUMBER

SE 1/4, Sec. 20, T 34 S, R 4 E

NOT FOR PUBLICATION

CITY, TOWN

Arkansas City

VICINITY OF

CONGRESSIONAL DISTRICT

5 Joe Skubitz

STATE

Kansas

CODE

20

COUNTY

Cowley

CODE

035

3 CLASSIFICATION

CATEGORY	OWNERSHIP	STATUS	PRESENT USE
<input type="checkbox"/> DISTRICT	<input type="checkbox"/> PUBLIC	<input checked="" type="checkbox"/> OCCUPIED	<input type="checkbox"/> AGRICULTURE
<input type="checkbox"/> BUILDING(S)	<input checked="" type="checkbox"/> PRIVATE	<input type="checkbox"/> UNOCCUPIED	<input type="checkbox"/> MUSEUM
<input type="checkbox"/> STRUCTURE	<input type="checkbox"/> BOTH	<input type="checkbox"/> WORK IN PROGRESS	<input type="checkbox"/> COMMERCIAL
<input checked="" type="checkbox"/> SITE	<input type="checkbox"/> PUBLIC ACQUISITION	<input type="checkbox"/> ACCESSIBLE	<input type="checkbox"/> EDUCATIONAL
<input type="checkbox"/> OBJECT	<input type="checkbox"/> IN PROCESS	<input checked="" type="checkbox"/> YES: RESTRICTED	<input type="checkbox"/> ENTERTAINMENT
	<input type="checkbox"/> BEING CONSIDERED	<input type="checkbox"/> YES: UNRESTRICTED	<input type="checkbox"/> GOVERNMENT
		<input type="checkbox"/> NO	<input type="checkbox"/> INDUSTRIAL
			<input type="checkbox"/> MILITARY
			<input checked="" type="checkbox"/> OTHER: recreat

4 OWNER OF PROPERTY

NAME Arkansas City Country Club

STREET & NUMBER

RFD

CITY, TOWN

Arkansas City

VICINITY OF

STATE

Kansas

5 LOCATION OF LEGAL DESCRIPTION

COURTHOUSE, REGISTER OF DEEDS, ETC. Register of Deeds

STREET & NUMBER

Cowley County Courthouse

CITY, TOWN

Winfield

STATE

Kansas

6 REPRESENTATION IN EXISTING SURVEYS

TITLE Archaeological Survey of Kansas

DATE

September, 1976

FEDERAL STATE COUNTY LOCAL

DEPOSITORY FOR SURVEY RECORDS

Kansas State Historical Society

CITY, TOWN

Topeka

STATE

Kansas

7 DESCRIPTION

CONDITION		CHECK ONE	CHECK ONE
<input checked="" type="checkbox"/> EXCELLENT	<input type="checkbox"/> DETERIORATED	<input type="checkbox"/> UNALTERED	<input checked="" type="checkbox"/> ORIGINAL SITE
<input type="checkbox"/> GOOD	<input type="checkbox"/> RUINS	<input checked="" type="checkbox"/> ALTERED	<input type="checkbox"/> MOVED DATE _____
<input type="checkbox"/> FAIR	<input checked="" type="checkbox"/> UNEXPOSED		

DESCRIBE THE PRESENT AND ORIGINAL (IF KNOWN) PHYSICAL APPEARANCE

The Arkansas City Country Club site consists of a series of man-made mounds scattered along a north-south ridge high above the Walnut river. Two of the mounds stand out conspicuously, each being approximately 1.5 meters high and 4 meters in diameter. They are located along the center line of the ridge toward its northern and highest end and are separated from each other by a distance of approximately 8 meters. The mounds scattered across the ridge south of these two are considerably smaller; all are less than a meter in height, most are less than 50 centimeters.

Thick grass covers the ridge and mounds but stone flakes and broken stone tools can be seen along golf cart tracks where the grass has been worn away. In places along the tracks there are distinct clusters of detritus which may represent mouths of storage pits. In one spot northeast of the largest mounds there is a distinct depression some 60 centimeters in diameter that may also mark the mouth of a storage pit. Other of these features are undoubtedly hidden by the sod cover.

The most complete account of excavations done at the site is that by Wedel describing his work of 1940. A 35 foot square test area was staked out over one of the small mounds. Excavation of this test showed the mound to be composed of aboriginal refuse overlaying three bell-shaped storage pits each about 60 inches deep. These pits were filled with quantities of stone flakes, animal bone, broken pottery, and stone tools. One pit contained a puebloan potsherd useful for cross-dating.

Other accounts of prior excavations at the site are vague. A large mound containing burials was excavated in 1916 before construction of the clubhouse. A few photographs of this event are on file at the Kansas State Historical Society but no other records are known. A number of mounds were dug into during the 1890's in the Arkansas City vicinity. Some of these mounds were located at the Country Club Site but other mound locations may have existed. Only partial, written accounts of this activity survive.

The smaller mounds are almost certainly undisturbed while the two larger show no obvious signs of disturbance. The site extended an unknown distance to the south of the country club property line in an area being developed for housing; however any significant evidence of the site in this area is now destroyed and it is not included in this nomination.

B SIGNIFICANCE

PERIOD	AREAS OF SIGNIFICANCE -- CHECK AND JUSTIFY BELOW			
<input checked="" type="checkbox"/> PREHISTORIC	<input checked="" type="checkbox"/> ARCHEOLOGY-PREHISTORIC	<input type="checkbox"/> COMMUNITY PLANNING	<input type="checkbox"/> LANDSCAPE ARCHITECTURE	<input type="checkbox"/> RELIGION
<input type="checkbox"/> 1400-1499	<input checked="" type="checkbox"/> ARCHEOLOGY-HISTORIC	<input type="checkbox"/> CONSERVATION	<input type="checkbox"/> LAW	<input type="checkbox"/> SCIENCE
<input checked="" type="checkbox"/> 1500-1599	<input type="checkbox"/> AGRICULTURE	<input type="checkbox"/> ECONOMICS	<input type="checkbox"/> LITERATURE	<input type="checkbox"/> SCULPTURE
<input checked="" type="checkbox"/> 1600-1699	<input type="checkbox"/> ARCHITECTURE	<input type="checkbox"/> EDUCATION	<input type="checkbox"/> MILITARY	<input type="checkbox"/> SOCIAL/HUMANITARIAN
<input type="checkbox"/> 1700-1799	<input type="checkbox"/> ART	<input type="checkbox"/> ENGINEERING	<input type="checkbox"/> MUSIC	<input type="checkbox"/> THEATER
<input type="checkbox"/> 1800-1899	<input type="checkbox"/> COMMERCE	<input type="checkbox"/> EXPLORATION/SETTLEMENT	<input type="checkbox"/> PHILOSOPHY	<input type="checkbox"/> TRANSPORTATION
<input type="checkbox"/> 1900-	<input type="checkbox"/> COMMUNICATIONS	<input type="checkbox"/> INDUSTRY	<input type="checkbox"/> POLITICS/GOVERNMENT	<input type="checkbox"/> OTHER (SPECIFY)
		<input type="checkbox"/> INVENTION		

SPECIFIC DATES Great Bend Aspect BUILDER/ARCHITECT
1500 AD--1700 AD

STATEMENT OF SIGNIFICANCE

The Country Club site is perhaps the central one of a group of large habitation sites located in the Arkansas City vicinity. These sites, taxonomically defined as the Lower Walnut Focus of the Great Bend Aspect, may be contemporaneous. They are related to large settlements located on the Little Arkansas river in central Kansas recognized as the Little River Focus (Wedel 1959: 571-89). The Little River Focus includes the Tobias-Thompson Archaeological Complex, a National Historic Landmark, and the Malone and Saxman sites, National Register properties. The sites in each locality were occupied in the late 16th and 17th centuries and those in the Arkansas City vicinity are thought to have been visited by a Spanish party under the leadership of Onate in 1601. The inhabitants of these large settlements were ancestral to the Wichita tribe.

Although the Lower Walnut sites have been positioned in the broad cultural/historical chronology developed for the Central Plains there are many detailed questions still to be answered. Among these is a question of the chronological relationship between sites located in central and southern Kansas. At the present time this relationship is based on the presence or absence of European trade goods and cross-dated sherds from New Mexican pueblos. Wedel hypothesized that the sites on the Lower Walnut were occupied for a longer time period and that this occupation traces the migration of the early Wichita to the south. (Wedel 1959: 586-589). The determination of a more accurate date for the occupation of the Country Club site would help confirm or refute this hypothesis.

Associated with this question of chronological sequence are others relating to cultural change. Despite many similarities to the material culture from other sites in the Great Bend Aspect, the sites in the Lower Walnut Focus have differences in the artifact inventory and architectural features that are unexplained and could reflect different behavioral patterns. Chief among these is the lack of any evidence for the existence of specialized structures termed "council circles" found in central Kansas. Most evidence to date indicates these specialized structures were probably constructed for ritual purposes. (Wedel 1967, 1968) The large mounds present at the Country Club site may have been built as temple foundations or for some other ritual purpose or they may have resulted from some more prosaic action. Excavation of one or both mounds could lead to the purpose behind their construction and provide a basis for comparison to the "council circles."

UNITED STATES DEPARTMENT OF THE INTERIOR
NATIONAL PARK SERVICE

FOR NPS USE ONLY
RECEIVED
DATE ENTERED

NATIONAL REGISTER OF HISTORIC PLACES
INVENTORY -- NOMINATION FORM

CONTINUATION SHEET

ITEM NUMBER

PAGE

8.

The excellent state of preservation of the subsurface features could lead to the recovery of house structure patterns, important since this information is lacking for Great Bend Aspect sites, and the quantities of bone refuse, pottery and stone artifacts could contribute to useful ecological and technological studies. The site has the potential to add significantly to our knowledge of the daily lives of its inhabitants and perhaps a unique opportunity to gain some knowledge of their esoteric beliefs.

9.

Wedel, Waldo R.

- 1967 The Council Circles of Central Kansas: Were They Solstice Registers?
American Antiquity, Volume 32, Number 1, Salt Lake City, pp. 54-63.
- 1968 After Coronado in Quivira. Kansas Historical Quarterly, Volume XXXIV,
Number 4, Topeka, pp. 369-385.

9 MAJOR BIBLIOGR. PHICAL REFERENCES

Wedel, Waldo R.

1959 An Introduction to Kansas Archaeology. Bureau of American Ethnology Bulletin, 174, Washington D.C., pp. 344-379.

10 GEOGRAPHICAL DATA

ACREAGE OF NOMINATED PROPERTY 150
 UTM REFERENCES

A	1,4	67,7	4,0,0	4,1	0,5	1,5,0	B	1,4	67,7	4,3,0	4,1	0,4	3,6,5
	ZONE	EASTING	NORTHING		ZONE	EASTING		ZONE	EASTING	NORTHING		ZONE	EASTING
C	1,4	67,6	3,8,5	4,1	0,4	3,4,5	D	1,4	67,6	8,2,0	4,1	0,5	1,6,5

VERBAL BOUNDARY DESCRIPTION

All land above the 1100 foot contour in the SE $\frac{1}{4}$, Sec. 20, T 34 S, R 4 E.

LIST ALL STATES AND COUNTIES FOR PROPERTIES OVERLAPPING STATE OR COUNTY BOUNDARIES

STATE	CODE	COUNTY	CODE
STATE	CODE	COUNTY	CODE

11 FORM PREPARED BY

NAME / TITLE

Martin Stein, Archaeologist

ORGANIZATION

Kansas State Historical Society

DATE

January 4, 1977

STREET & NUMBER

120 West 10th

TELEPHONE

913 296-5294

CITY OR TOWN

Topeka

STATE

Kansas

12 STATE HISTORIC PRESERVATION OFFICER CERTIFICATION

THE EVALUATED SIGNIFICANCE OF THIS PROPERTY WITHIN THE STATE IS:

NATIONAL

STATE

LOCAL

As the designated State Historic Preservation Officer for the National Historic Preservation Act of 1966 (Public Law 89-665), I hereby nominate this property for inclusion in the National Register and certify that it has been evaluated according to the criteria and procedures set forth by the National Park Service.

FEDERAL REPRESENTATIVE SIGNATURE

Joseph M. Sull

TITLE

Executive Director, Kansas State Historical Society

DATE April 21, 1977

FOR NPS USE ONLY

I HEREBY CERTIFY THAT THIS PROPERTY IS INCLUDED IN THE NATIONAL REGISTER

DATE

DIRECTOR, OFFICE OF ARCHEOLOGY AND HISTORIC PRESERVATION

ATTEST:

DATE

KEEPER OF THE NATIONAL REGISTER

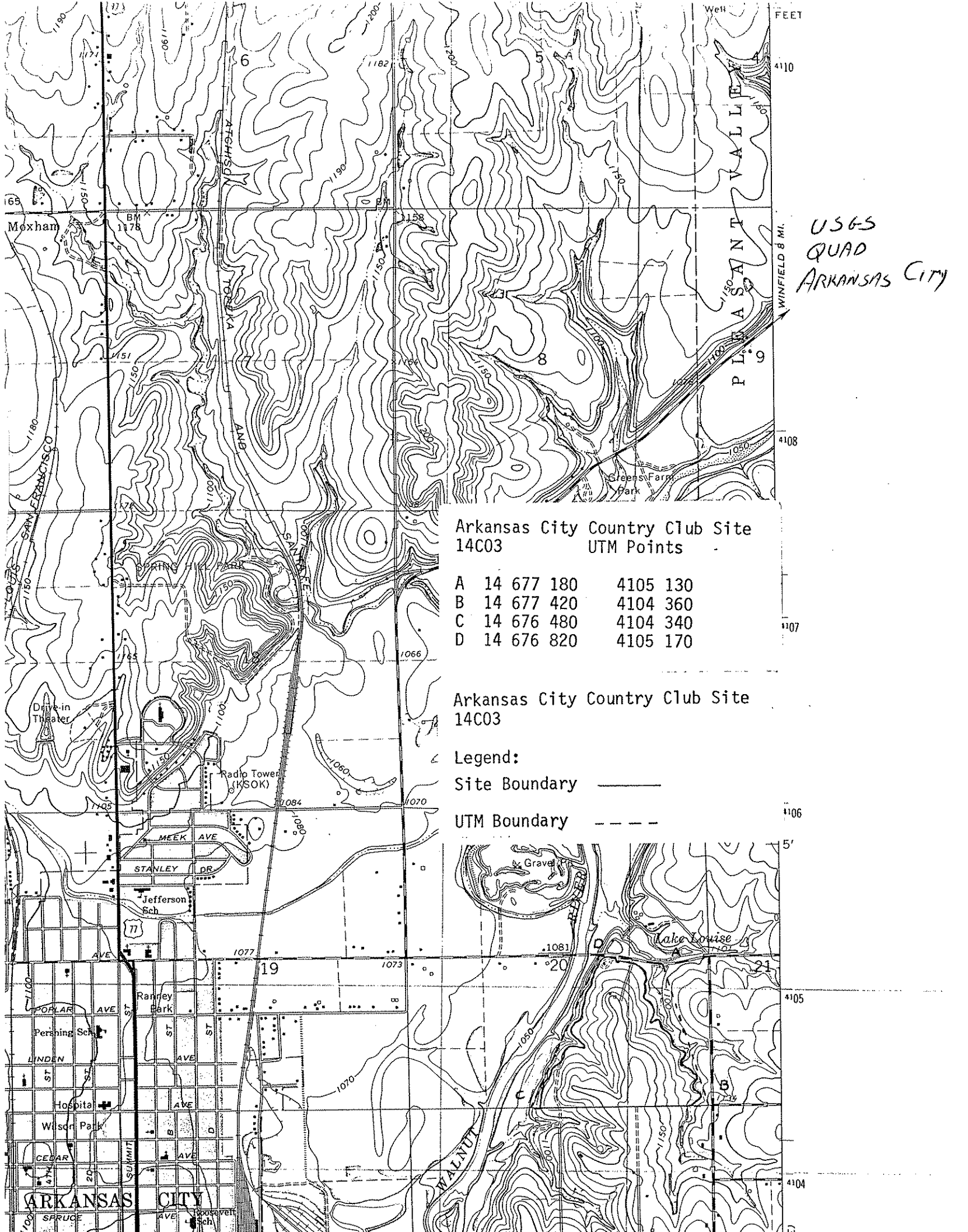

USGS
QUAD
ARKANSAS CITY

Arkansas City Country Club Site
14C03 UTM Points

A	14 677 180	4105 130
B	14 677 420	4104 360
C	14 676 480	4104 340
D	14 676 820	4105 170

Arkansas City Country Club Site
14C03

- Legend:
- Site Boundary ———
 - UTM Boundary - - - - -

