

FOR RECONSTRUCTED SEPT. 25, 1974

Form 10-300
(Rev. 6-72)

UNITED STATES DEPARTMENT OF THE INTERIOR
NATIONAL PARK SERVICE

**NATIONAL REGISTER OF HISTORIC PLACES
INVENTORY - NOMINATION FORM**

(Type all entries - complete applicable sections)

STATE: Kansas
COUNTY: Doniphan
FOR NPS USE ONLY
ENTRY DATE

1. NAME

COMMON:
Poulet House

AND/OR HISTORIC:

2. LOCATION

STREET AND NUMBER:
On the south side of Poplar St., between First and Second Sts.

CITY OR TOWN:
White Cloud

CONGRESSIONAL DISTRICT:
no. 2, Bill Roy

STATE: **Kansas** CODE: **20** COUNTY: **Doniphan** CODE: **043**

3. CLASSIFICATION

CATEGORY (Check One)	OWNERSHIP	STATUS	ACCESSIBLE TO THE PUBLIC
<input type="checkbox"/> District <input checked="" type="checkbox"/> Building <input type="checkbox"/> Site <input type="checkbox"/> Structure <input type="checkbox"/> Object	<input type="checkbox"/> Public <input checked="" type="checkbox"/> Private <input type="checkbox"/> Both	Public Acquisition: <input type="checkbox"/> In Process <input type="checkbox"/> Being Considered	<input type="checkbox"/> Occupied <input checked="" type="checkbox"/> Unoccupied <input type="checkbox"/> Preservation work in progress
PRESENT USE (Check One or More as Appropriate)			
<input type="checkbox"/> Agricultural <input type="checkbox"/> Commercial <input type="checkbox"/> Educational <input type="checkbox"/> Entertainment	<input type="checkbox"/> Government <input type="checkbox"/> Industrial <input type="checkbox"/> Military <input type="checkbox"/> Museum	<input type="checkbox"/> Park <input type="checkbox"/> Private Residence <input type="checkbox"/> Religious <input type="checkbox"/> Scientific	<input type="checkbox"/> Transportation <input checked="" type="checkbox"/> Other (Specify) NONE
<input type="checkbox"/> Comments			

4. OWNER OF PROPERTY

OWNER'S NAME:

STREET AND NUMBER:

CITY OR TOWN: STATE: CODE:

5. LOCATION OF LEGAL DESCRIPTION

COURTHOUSE, REGISTRY OF DEEDS, ETC.:
Register of Deeds

STREET AND NUMBER:
Doniphan County Courthouse

CITY OR TOWN: **Troy** STATE: **Kansas** CODE: **043**

6. REPRESENTATION IN EXISTING SURVEYS

TITLE OF SURVEY:
Federal Writers' Project of the Works Progress Administration

DATE OF SURVEY: **1939** Federal State County Local

DEPOSITORY FOR SURVEY RECORDS:
Records destroyed. A guide book, Kansas was published in 1939.

STREET AND NUMBER:

CITY OR TOWN: STATE: CODE:

SEE INSTRUCTIONS

STATE: **Kansas**

COUNTY: **Doniphan**

ENTRY NUMBER

DATE

FOR NPS USE ONLY

7. DESCRIPTION

CONDITION	(Check One)				
	<input type="checkbox"/> Excellent	<input type="checkbox"/> Good	<input type="checkbox"/> Fair	<input checked="" type="checkbox"/> Deteriorated	<input type="checkbox"/> Ruins
	(Check One)		(Check One)		
	<input checked="" type="checkbox"/> Altered	<input type="checkbox"/> Unaltered	<input type="checkbox"/> Moved	<input checked="" type="checkbox"/> Original Site	

DESCRIBE THE PRESENT AND ORIGINAL (if known) PHYSICAL APPEARANCE

The Poulet House, a rectangular three-story building with a tower over its main entrance, stands on a hillside overlooking the business district of White Cloud. It is built of red brick and has a three-piece arched stone lintel over each opening. The tower, which is square, sits in the center of the front of the building. It acts as an accent to the main entrance which goes through the tower. There is one large window just over the entrance and two smaller windows near the top on each side of the tower. A two-story wooden porch which was attached to the tower has been removed.

There is a hip roof on the main part of the house while the tower has four gables. All roofing is of wood shingles.

Only two stories are visible from the front because of the sloping site. The back view exposes all three floors and two balconies with metal railings. The second floor balcony runs the full length of the building while the third floor balcony runs about two-thirds the length and is centered on the building. At even intervals under the eaves are pairs of wood brackets.

The interior has plaster walls and wood floors. It also has only one interior stairway.

SEE INSTRUCTIONS

SIGNIFICANCE

PERIOD (Check One or More as Appropriate)

- | | | | |
|--|---------------------------------------|--|---------------------------------------|
| <input type="checkbox"/> Pre-Columbian | <input type="checkbox"/> 16th Century | <input type="checkbox"/> 18th Century | <input type="checkbox"/> 20th Century |
| <input type="checkbox"/> 15th Century | <input type="checkbox"/> 17th Century | <input checked="" type="checkbox"/> 19th Century | |

SPECIFIC DATE(S) (If Applicable and Known) 1880

AREAS OF SIGNIFICANCE (Check One or More as Appropriate)

- | | | | |
|--|---|--|--|
| <input type="checkbox"/> Aboriginal | <input type="checkbox"/> Education | <input type="checkbox"/> Political | <input type="checkbox"/> Urban Planning |
| <input type="checkbox"/> Prehistoric | <input type="checkbox"/> Engineering | <input type="checkbox"/> Religion/Philosophy | <input type="checkbox"/> Other (Specify) |
| <input type="checkbox"/> Historic | <input type="checkbox"/> Industry | <input type="checkbox"/> Science | _____ |
| <input type="checkbox"/> Agriculture | <input type="checkbox"/> Invention | <input type="checkbox"/> Sculpture | _____ |
| <input checked="" type="checkbox"/> Architecture | <input type="checkbox"/> Landscape Architecture | <input type="checkbox"/> Social/Humanitarian | _____ |
| <input type="checkbox"/> Art | <input type="checkbox"/> Literature | <input type="checkbox"/> Theater | _____ |
| <input type="checkbox"/> Commerce | <input type="checkbox"/> Military | <input type="checkbox"/> Transportation | _____ |
| <input type="checkbox"/> Communications | <input type="checkbox"/> Music | | _____ |
| <input type="checkbox"/> Conservation | | | _____ |

STATEMENT OF SIGNIFICANCE

The Poulet House was built about 1880 by Alexis Poulet, a White Cloud businessman. A native of France, Poulet came to Missouri in 1847 at the age of 16. After spending several years in Missouri and also New Orleans, he settled in 1857 at Iowa Point in Doniphan county, Kansas, where he operated a general merchandising business. After the Civil War he moved to White Cloud and operated successively a hardware store, a general mercantile business, and a bank. He became one of the most prominent men of the area.

The Poulet House is a good example of early residential architecture, built of brick and executed in the Renaissance influence style, complete with a rear balconied facade.

SEE INSTRUCTIONS

9 MAJOR BIBLIOGRAPHICAL REFERENCES

Beachy, E. B. Dykes, "History and Scenery Are Mingled in the Far Northeast Corner of Kansas," Kansas City Times, September 15, 1951.
Kansas, A Cyclopedia of State History (Chicago, Standard Publishing Co., 1912), v. 3, pt. 2, pp. 1326, 1327.
 MacDonald, A. B., "White Cloud, Kas., Has Retained the Culture of Its Pioneer Founders," Kansas City Star. May 24, 1936.
 "A Visit to Old White Cloud," Sabetha Herald, June 9, 1943.

10 GEOGRAPHICAL DATA

LATITUDE AND LONGITUDE COORDINATES DEFINING A RECTANGLE LOCATING THE PROPERTY				O R	LATITUDE AND LONGITUDE COORDINATES DEFINING THE CENTER POINT OF A PROPERTY OF LESS THAN TEN ACRES							
CORNER	LATITUDE				LONGITUDE			LATITUDE			LONGITUDE	
	Degrees	Minutes	Seconds	Degrees	Minutes	Seconds	Degrees	Minutes	Seconds	Degrees	Minutes	Seconds
NW	0		"	0		"	0		"	0		"
NE	0		"	0		"	39	59	00	95	17	49
SE	0		"	0		"						
SW	0		"	0		"						

APPROXIMATE ACREAGE OF NOMINATED PROPERTY: less than 1

LIST ALL STATES AND COUNTIES FOR PROPERTIES OVERLAPPING STATE OR COUNTY BOUNDARIES

STATE:	CODE	COUNTY:	CODE

11 FORM PREPARED BY

NAME AND TITLE: Charles L. Hall, Architectural Consultant
Richard Pankratz, Director, Historic Sites Survey

ORGANIZATION: Kansas State Historical Society DATE: April 6, 1971

STREET AND NUMBER: 120 West Tenth

CITY OR TOWN: Topeka STATE: Kansas 66612 CODE: 20

12 STATE LIAISON OFFICER CERTIFICATION **NATIONAL REGISTER VERIFICATION**

As the designated State Liaison Officer for the National Historic Preservation Act of 1966 (Public Law 89-665), I hereby nominate this property for inclusion in the National Register and certify that it has been evaluated according to the criteria and procedures set forth by the National Park Service. The recommended level of significance of this nomination is:

National State Local

Name Nyle H. Miller

Title _____

Date Sent to NR: 4/19/75

I hereby certify that this property is included in the National Register.

 Director, Office of Archeology and Historic Preservation

Date _____

ATTEST:

 Keeper of The National Register

Date _____

SEE INSTRUCTIONS

KANSAS HISTORIC RESOURCES INVENTORY

1a. Property name, historic (050) Alois Poulet residence		14. KSHS Inventory Code (054) 043-5850-0001	
b. Property name, common		15. County (064) Doniphan	16. Survey sequence no. WC 6
2. Property address/descriptive location (062) South side of Poplar between 1st & 2nd White Cloud		17. Accessibility <input type="checkbox"/> open to public <input checked="" type="checkbox"/> accessible by permission only <input type="checkbox"/> inaccessible	18. Visibility from public road or street <input checked="" type="checkbox"/> good <input type="checkbox"/> poor <input type="checkbox"/> not visible
3. Legal description (070) Lots 2 & 3 less W 14' Lot 2, Block 34, Original Town		19. Condition (084) <input checked="" type="checkbox"/> excellent <input type="checkbox"/> ruins <input type="checkbox"/> good <input type="checkbox"/> no visible remains <input type="checkbox"/> fair <input type="checkbox"/> incorporated into later structure <input type="checkbox"/> deteriorated	
4. Original use residence	5. Present use (208) residence	20. USGS quadrangle map # required (see instructions) White Cloud	
6. Other uses	7. Original owner or occupant Alois Poulet	21. UTM reference if required (see instructions)	
8. Date of construction (301) <input checked="" type="checkbox"/> estimated 1878 <input type="checkbox"/> documented	9. Changes dates <input type="checkbox"/> moved <input type="checkbox"/> major alterations	22. Current owner's name and address (096, 097) <i>Mrs. E. F. ...</i>	
10. Architect (300) unknown	11. Builder/contractor unknown	23. Tenant's name, and address if different from property address (see instructions)	
12. Is the property architecturally or historically important? If so, why? (continue on reverse if necessary) This house is on National Register		24. Principal material(s) (216) brick and stone	
13. Identify any outbuildings and/or other structures associated with this building or structure. (Attach an additional inventory form for each one that has particular architectural or historical interest.)		25. Style and/or form type (210) Italianate Villa; hip roof	

THIS SECTION FOR KSHS USE ONLY

26. Category (060) <i>Building</i>
27. Functional type (202) <i>Residential House</i>
28. Registration status and dates (078) <input type="checkbox"/> NHL <input checked="" type="checkbox"/> listed NR 9/3/71 <input type="checkbox"/> approved for NR <input type="checkbox"/> federal DOE <input checked="" type="checkbox"/> listed SR <input type="checkbox"/> local landmark <input type="checkbox"/> HABS/HAER
29. Is this property included in a historic district? <input type="checkbox"/> yes <input type="checkbox"/> NR district <input type="checkbox"/> no <input type="checkbox"/> SR district <input type="checkbox"/> proposed <input type="checkbox"/> local district Name of district (080) <input type="checkbox"/> contributing <input type="checkbox"/> noncontributing



30. Brief statement of the property's history

Please see National Register nomination

31. Brief description. If a thorough description has been prepared separately, disregard this section and check here .

Please see National Register nomination

32. Additional remarks or continuation of other sections

See # WC 40

35. Photographer or photo source

Nancy Sandehn

36. Photo roll and frame number(s)

94: 3a

37. Photo date

winter 1984

33. Sources of information

38. Inventory form completed by
(name and organization)

Nancy Sandehn
Mo-Kan Regional Council
1302 Faraon
St. Joseph, MO 64501

39. Survey project name

Doniphan County Towns

40. Date form compiled

September 1985

34. Sketch of site plan. (Include north arrow. Show outline of building shape and locations of outbuildings.)

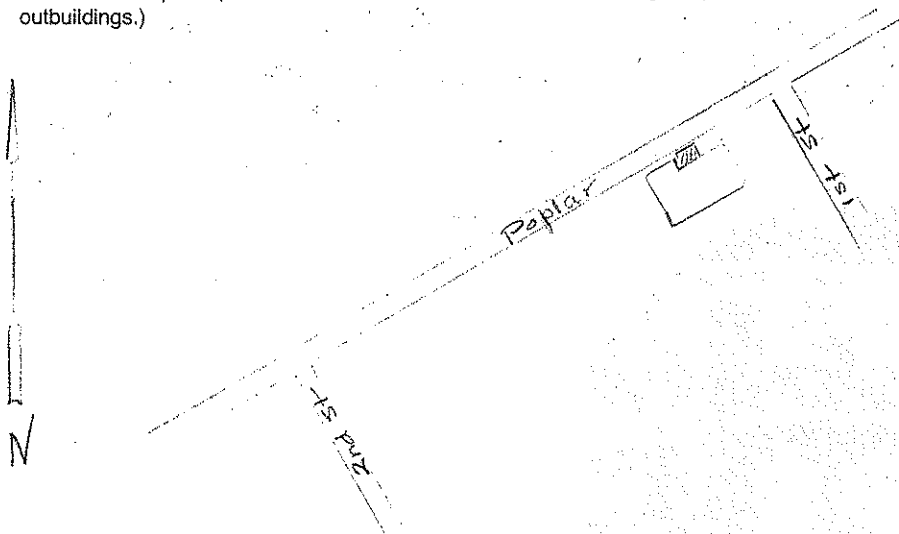

THIS SECTION FOR KSHS USE ONLY

41. Attached supplementary materials

42. Other materials in KSHS/HPD files

- plans, drawings
- correspondence
- research notes
- clippings
- project report
- early photos
- other

43. Date logged, HPD

3/12/87

44. Logged by

BA