

NATIONAL REGISTER OF HISTORIC PLACES
INVENTORY - NOMINATION FORM

(Type all entries - complete applicable sections)

STATE: .sas	
COUNTY: Douglas	
FOR NPS USE ONLY	
ENTRY NUMBER	DATE
7/12.20.0013	2/24/71

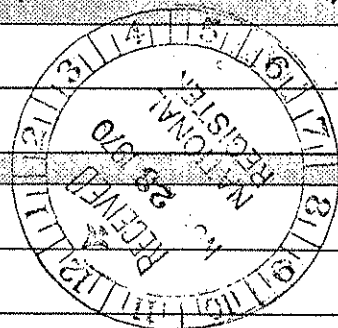

1. NAME

COMMON: Old Castle Hall

AND/OR HISTORIC:

2. LOCATION

STREET AND NUMBER: 513 Fifth St. S.E.

CITY OR TOWN: Baldwin

STATE: Kansas 66006 CODE: 20 COUNTY: Douglas CODE: 045

3. CLASSIFICATION

CATEGORY (Check One)	OWNERSHIP	STATUS	ACCESSIBLE TO THE PUBLIC
<input type="checkbox"/> District <input checked="" type="checkbox"/> Building <input type="checkbox"/> Site <input type="checkbox"/> Structure <input type="checkbox"/> Object	<input type="checkbox"/> Public <input checked="" type="checkbox"/> Private <input type="checkbox"/> Both	Public Acquisition: <input type="checkbox"/> In Process <input type="checkbox"/> Being Considered	<input checked="" type="checkbox"/> Occupied <input type="checkbox"/> Unoccupied <input type="checkbox"/> Preservation work in progress
PRESENT USE (Check One or More as Appropriate)			
<input type="checkbox"/> Agricultural <input type="checkbox"/> Commercial <input type="checkbox"/> Educational <input type="checkbox"/> Entertainment	<input type="checkbox"/> Government <input type="checkbox"/> Industrial <input type="checkbox"/> Military <input checked="" type="checkbox"/> Museum	<input type="checkbox"/> Park <input type="checkbox"/> Private Residence <input type="checkbox"/> Religious <input type="checkbox"/> Scientific	<input type="checkbox"/> Transportation <input type="checkbox"/> Other (Specify)
Yes: <input checked="" type="checkbox"/> Restricted <input type="checkbox"/> Unrestricted <input type="checkbox"/> No			

4. OWNER OF PROPERTY

OWNER'S NAME: Baker University

STREET AND NUMBER:

CITY OR TOWN: Baldwin STATE: Kansas 66006 CODE: 20

5. LOCATION OF LEGAL DESCRIPTION

COURTHOUSE, REGISTRY OF DEEDS, ETC.: Register of Deeds

STREET AND NUMBER: Douglas County Courthouse

CITY OR TOWN: Lawrence STATE: Kansas 66044 CODE: 20

6. REPRESENTATION IN EXISTING SURVEYS

TITLE OF SURVEY: National Survey of Historic Sites and Buildings

DATE OF SURVEY: Federal State County Local

DEPOSITORY FOR SURVEY RECORDS: Office of Archeology and Historic Preservation

STREET AND NUMBER: 801 19th St., N. W.

CITY OR TOWN: Washington STATE: District of Columbia CODE: 11

STATE: Kansas

COUNTY: Douglas

FOR NPS USE ONLY

ENTRY NUMBER: 7/12.20.0013

DATE: 2/24/71

SEE INSTRUCTIONS

7. DESCRIPTION

CONDITION

(Check One)
 Excellent Good Fair Deteriorated Ruins Unexposed

(Check One) Altered Unaltered (Check One) Moved Original Site

DESCRIBE THE PRESENT AND ORIGINAL (if known) PHYSICAL APPEARANCE

Old Castle Hall, a crudely quoined three-story rubble stone building, originally consisted of only two stories. The third story was added later and then afterwards torn off because of poor mortar joints; it was then added for a second time and remains to date.

A simple rectangular plan is carried through to the straight gable roof. All window and door openings are rectangular with heavy stone lintels and sills.

The second and third floor levels are clearly visible because of the beams which extend through the exterior wall surfaces. The old two story roof line is also clearly visible on the back side of the structure.

Although the interior has been renovated many times over the years, the existing plan and interior are considered to be very close to the original conditions.

SEE INSTRUCTIONS

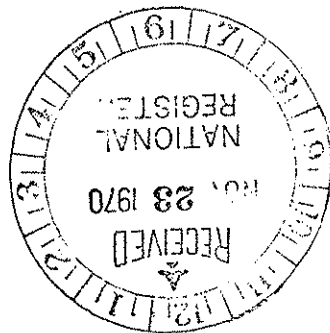

B. SIGNIFICANCE

PERIOD (Check One or More as Appropriate)

- Pre-Columbian | 16th Century | 18th Century | 20th Century
 15th Century | 17th Century | 19th Century

SPECIFIC DATE(S) (If Applicable and Known) 1858

AREAS OF SIGNIFICANCE (Check One or More as Appropriate)

- | | | | |
|--|---|--|--|
| <input type="checkbox"/> Aboriginal | <input checked="" type="checkbox"/> Education | <input type="checkbox"/> Political | <input type="checkbox"/> Urban Planning |
| <input type="checkbox"/> Prehistoric | <input type="checkbox"/> Engineering | <input type="checkbox"/> Religion/Philosophy | <input type="checkbox"/> Other (Specify) |
| <input type="checkbox"/> Historic | <input type="checkbox"/> Industry | <input type="checkbox"/> Science | _____ |
| <input type="checkbox"/> Agriculture | <input type="checkbox"/> Invention | <input type="checkbox"/> Sculpture | _____ |
| <input checked="" type="checkbox"/> Architecture | <input type="checkbox"/> Landscape Architecture | <input type="checkbox"/> Social/Humanitarian | _____ |
| <input type="checkbox"/> Art | <input type="checkbox"/> Literature | <input type="checkbox"/> Theater | _____ |
| <input type="checkbox"/> Commerce | <input type="checkbox"/> Military | <input type="checkbox"/> Transportation | _____ |
| <input type="checkbox"/> Communications | <input type="checkbox"/> Music | | _____ |
| <input type="checkbox"/> Conservation | | | _____ |

STATEMENT OF SIGNIFICANCE

On February 3, 1858, the Kansas Education Association of the Methodist Episcopal Church received a charter from the territorial legislature to establish a college at or near Palmyra, and on February 12 a charter was granted for Baker University. As an inducement to the Methodists to locate the college at Palmyra, the town association gave them a section of land adjacent to the town site. The section was surveyed into lots and over the years most of the land was sold to raise money for construction and operating expenses.

Construction of a temporary college building one block off the campus began in late 1857 or early 1858, and its doors were opened for students November 22, 1858. It was erected off campus because school trustees lacked sufficient funds to build the type of permanent structure they desired and they did not want to erect a temporary building on the campus. College officials could raise only enough funds to construct two stories of the planned three-story structure. The Palmyra Masonic lodge financed the third floor in exchange for regular use of a room for lodge meetings.

After another building was completed in 1871, the Old Castle Hall was no longer used for classes. In 1874 the president of the college, Joseph Denison, used it as his home. Among others, uses over the years have been as a mill, a student rooming house, a public school, and a storage place for athletic materials and other college property.

The third floor was removed during the time it was used as a mill, reportedly because vibrations of the mill machinery had weakened it. When Baker University celebrated its fiftieth anniversary, the third floor was rebuilt. In the 1950's extensive restoration work was carried out by the Old Castle Memorial association, and today the building is maintained as a museum.

Old Castle Hall was the first building of Baker University, which is today the oldest four-year college in the state. Architecturally it is a very fine example of early Plains Vernacular architecture as adapted to a multistory building.

SEE INSTRUCTIONS

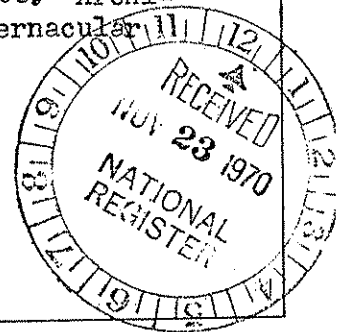

9. MAJOR BIBLIOGRAPHICAL REFERENCES

Ebright, Homer Kinley, The History of Baker University (Baldwin, Kan., n. p., 1951), pp. 64-67.
 Evans, Thomas A., "Baker, Oldest University in Kansas," Jayhawk, The Magazine of Kansas, v. 2, no. 1 (January, 1929), pp. 7, 8, 32.
History of the State of Kansas (Chicago, A. T. Andreas, 1883), v. 1, p. 355.
 Markham, W. C., "Oldest College in Kansas," Topeka Mail and Breeze, May 20, 1898.
Minutes of the Fourth Session of the Kansas and Nebraska Annual Conference of the Methodist E. Church (Omaha, N. T., Robertson and Clark, 1859), p. 11.

10. GEOGRAPHICAL DATA

LATITUDE AND LONGITUDE COORDINATES DEFINING A RECTANGLE LOCATING THE PROPERTY			O R	LATITUDE AND LONGITUDE COORDINATES DEFINING THE CENTER POINT OF A PROPERTY OF LESS THAN TEN ACRES		
CORNER	LATITUDE	LONGITUDE		LATITUDE	LONGITUDE	
	Degrees Minutes Seconds	Degrees Minutes Seconds	Degrees	Minutes	Seconds	
NW	° ' "	° ' "	°	'	"	
NE	° ' "	° ' "	38	46	38	
SE	° ' "	° ' "	95	11	04	
SW	° ' "	° ' "				

APPROXIMATE ACREAGE OF NOMINATED PROPERTY: 7

LIST ALL STATES AND COUNTIES FOR PROPERTIES OVERLAPPING STATE OR COUNTY BOUNDARIES

STATE:	CODE	COUNTY	CODE

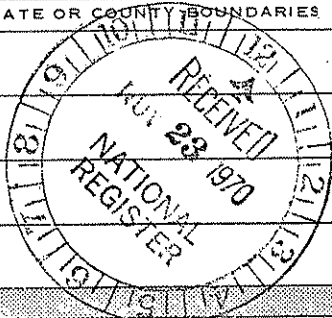

11. FORM PREPARED BY

NAME AND TITLE: Charles L. Hall, Architectural Consultant
 Richard D. Pankratz, Planner

ORGANIZATION: Kansas State Historical Society

DATE: Sept. 25, 1970

STREET AND NUMBER: 120 West Tenth St.

CITY OR TOWN: Topeka

STATE: Kansas 66612

CODE: 20

12. STATE LIAISON OFFICER CERTIFICATION NATIONAL REGISTER VERIFICATION

As the designated State Liaison Officer for the National Historic Preservation Act of 1966 (Public Law 89-665), I hereby nominate this property for inclusion in the National Register and certify that it has been evaluated according to the criteria and procedures set forth by the National Park Service. The recommended level of significance of this nomination is:

National State Local

Name: Nyle H. Miller
 Nyle H. Miller

Title: Executive Secretary, Kansas State Historical Society

Date: Oct. 21, 1970

I hereby certify that this property is included in the National Register.

Ernest A. Connolly
 Chief, Office of Archeology and Historic Preservation

FEB 24 1971

Date: _____

ATTEST:

William Whentz
 Keeper of The National Register

Date: JAN 20 1971

SEE INSTRUCTIONS

NATIONAL REGISTER OF HISTORIC PLACES
INVENTORY - NOMINATION FORM

(Continuation Sheet)

STATE Kansas	
COUNTY Douglas	
FOR NPS USE ONLY	
ENTRY NUMBER	DATE
71.2.20.0013	2/24/71

(Number all entries)

6.

Survey of Historic Sites and Structures in Kansas (State)
1957
Kansas State Historical Society
120 West Tenth St.
Topeka, Kansas 66612

Code: 20

Federal Writers' Project of the Works Project Administration
1939 (Federal)

Records destroyed. A guide book, Kansas, was published in 1939.

9.

Rohrer, Lee Ann, "Baker's 'Old Castle' Relates Many Tales,"
Lawrence Journal-World, May 30, 1957.

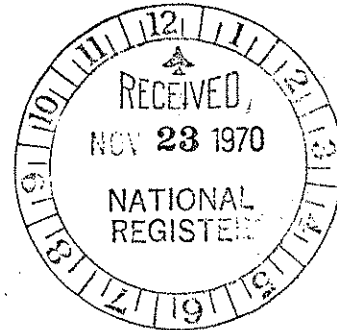

NATIONAL REGISTER OF HISTORIC PLACES
PROPERTY MAP FORM

(Type all entries - attach to or enclose with map)

STATE Kansas	
COUNTY Douglas	
FOR NPS USE ONLY	
ENTRY NUMBER 91.2.20.0013	DATE 2/24/71

SEE INSTRUCTIONS

1. NAME			
COMMON: Old Castle Hall			
AND/OR HISTORIC:			
2. LOCATION			
STREET AND NUMBER: 513 Fifth St.			
CITY OR TOWN: Baldwin			
STATE: Kansas 66006	CODE 20	COUNTY: Douglas	CODE 045
3. MAP REFERENCE			
SOURCE: U. S. G. S. 7½' Quadrangle, Baldwin City, Kansas			
SCALE: 1: 24,000			
DATE: 1957			
4. REQUIREMENTS			
TO BE INCLUDED ON ALL MAPS			
1. Property boundaries where required.			
2. North arrow.			
3. Latitude and longitude reference.			

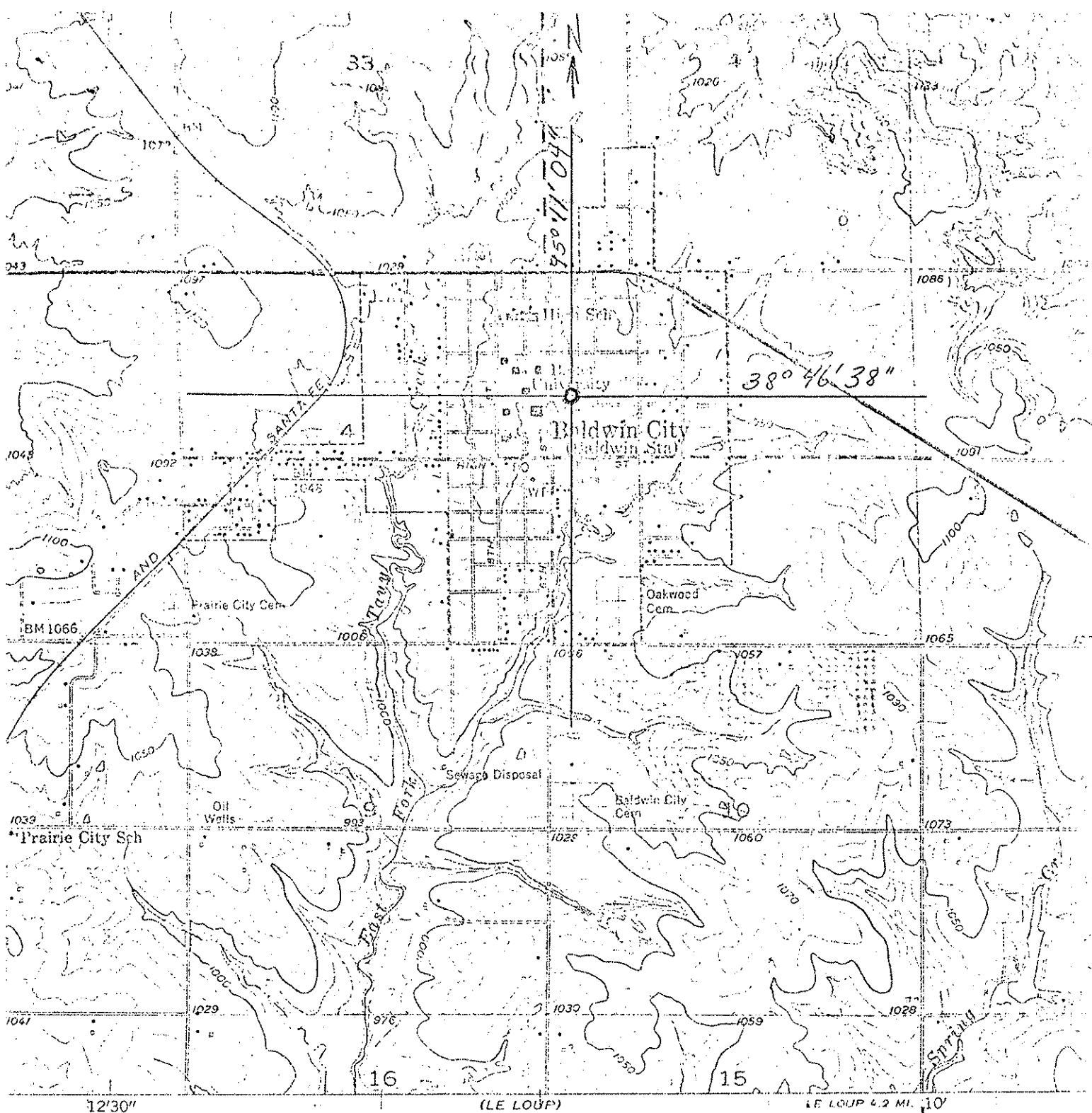

SCALE 1:24000

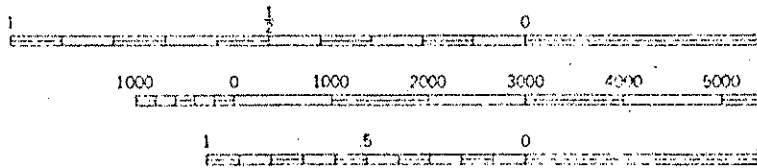

CONTOUR INTERVAL 10 FEET
DATUM IS MEAN SEA LEVEL

U. S. G. S. 7½' Quadrangle
Map Baldwin City (1957)
Scale 1: 24,000
Lat. 38° 46' 38"
Long. 95° 11' 04"